

SCREENED

INTAKE

EXPLODED

VIEW

9/27/2016

Revision History

#	Description	Revised by	ECN#	Date
0	Released to production	JTS	1882	2/15/10
1	Discharge Screen HEMS	NR	2902	9/28/16

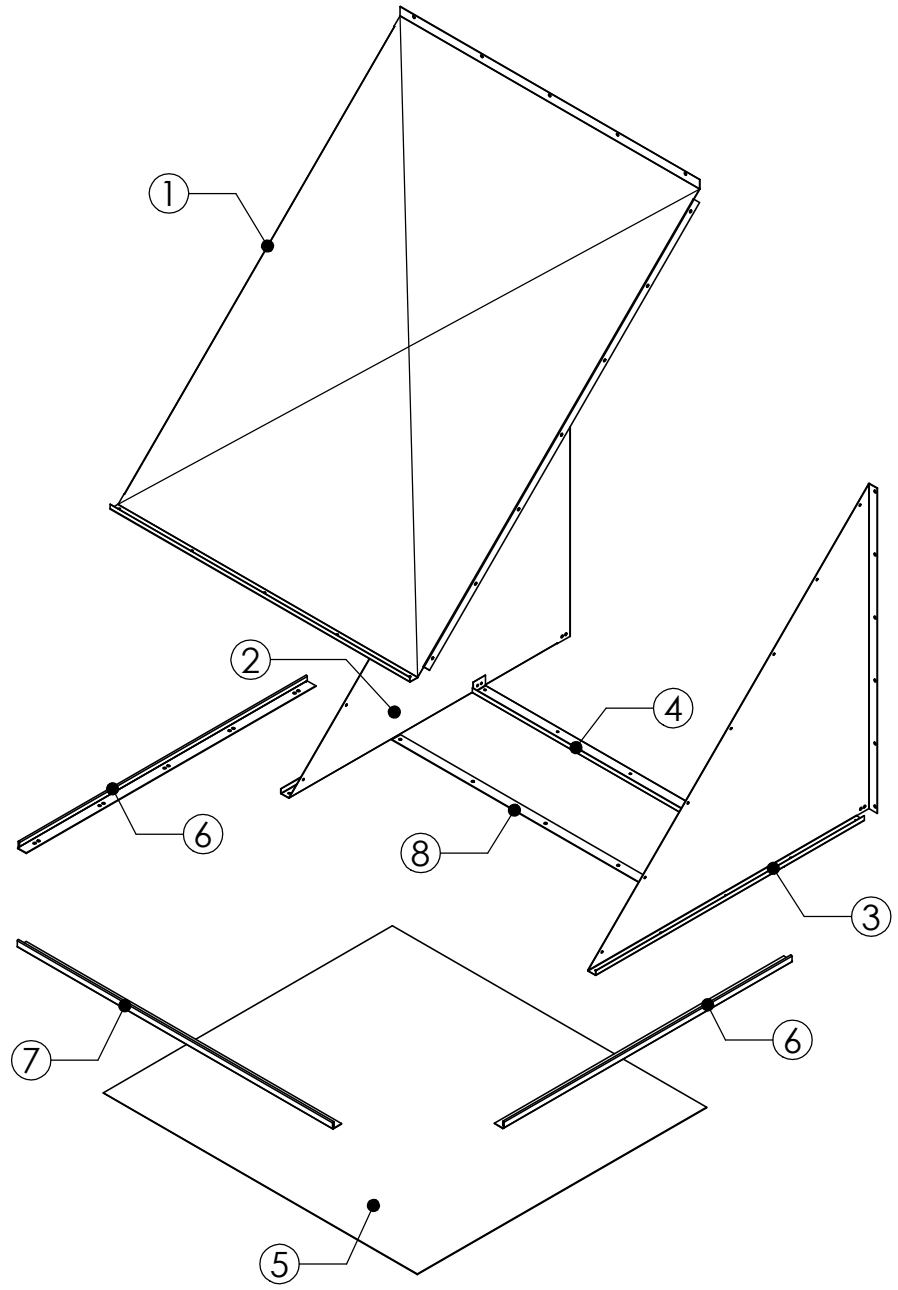

Part Numbers with the suffix of "-SS" are made from Stainless Steel.

All mating flanges will receive 1/4" x 1" grey gasketing.

Top and sides of the Stainless Steel assemblies will be insulated with foil faced, 1" thick insulation.

Number	Description	Unit Size				
		Size 1	Size 2	Size 3	Size 4	Size 5
1	Top	S1TOPP	S2TOPP	S3TOPP	S4TOPP	S5TOPP
2	Right Side	S1RSID	S2RSID	S3RSID	S4RSID	S5RSID
3	Left Side	S1LSID	S2LSID	S3LSID	S4LSID	S5LSID
4	Bottom	S1BOTT	S2BOTT	S3BOTT	S4BOTT	S5BOTT
5	Screen	S1ISCN	S2ISCN	S3ISCN	S4ISCN	S5ISCN
6	Long Screen Hold Down	S1VSHD (2)	S2VSHD (2)	S3VSHD (2)	S4VSHD (2)	S5VSHD (2)
7	Short Screen Hold Down -HEM	S1HSHDHEM	S2HSHDHEM	S3HSHDHEM	S4HSHDHEM	S5VSHDHEM
8	Short Screen Hold Down - NO HEM	S1HSHD	S2HSHD	S3HSHD	S4HSHD	S5VSHD

Material: N/A
 Blank Size: N/A x N/A
 Weight: N/A lbs

Part Number: N/A
 MACOLA/AX Number: N/A
 Drawing Name: Screened Intake Exploded View
 Drawn By: JTS
 Parent Assembly: Screened Intake
 Sheet: 2 of 2

Unless Otherwise Specified
 Dimensions are in Inches.

Standard Tolerances are:
 Fractions: ±1/16
 Decimal: .XX±.05
 .XXX±.015
 Angles: ±1°

CONFIDENTIAL